

Bullivants

Snatch Block



The Bullivants Snatch Block is designed to redirect a loaded wire rope when a change in direction is needed, such as when installing precast concrete panels. This snatch block features a single sheave and is primarily used as a lifting accessory with slings or to increase line pull in winching applications, rather than as an integral part of a crane, which is often the case with sheave blocks.

With side plate opening feature, this is particularly useful as it is often impractical to thread a wire rope sling through a sheave block.

Features & Benefits:

- Side plates – open to allow block to be placed on a wire rope at any point during a winching operation or to insert wire ring slings.
- Identification tag with serial number
- Proof tested to 2 x WLL with certificate
- Constructed with swivel shackle head fitting
- Heavy duty construction & powder coated
- Designed and manufactured to AS 2089

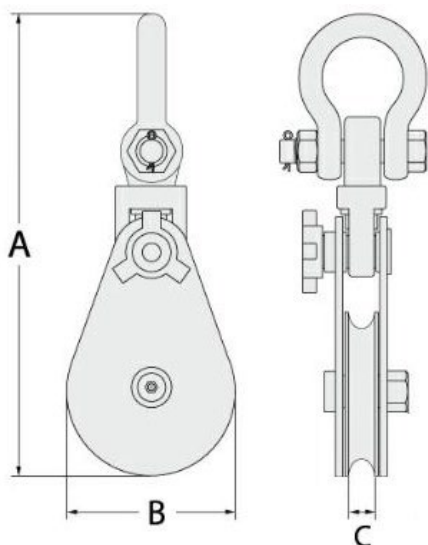

Specifications:

Bullivants Mfr No.	Rated Capacity tonne	Outside Sheave Diameter mm	Wire Rope Diameter mm	A mm	B mm	C mm	Net Weight kg
WSNB-02T-115-S-BS-BV	2.0	115	7-9	325	122	32	5.5
WSNB-04T-210-S-BS-BV	4.0	210	10-14	471	220	32	12.3
WSNB-06T-275-S-BS-BV	6.0	275	13-16	625	285	48	27.5
WSNB-08T-275-S-BS-BV	8.0	275	16-18	625	285	48	28.5
WSNB-10T-250-S-BS-BV	10.0	250	18-20	685.5	260	53.5	36.5
WSNB-12T-395-S-BS-BV	12.0	395	20-26	831.5	410	63.5	75