



### Main Features:

- Clevis pin for direct connection to chain without connecting link
- Fitted with spring loaded latch
- 25% Stronger than Grade 80 equivalent
- Individually tested to 2 x WLL
- Surface finish: White powder coated
- Complies with AS 3776

### ZERO HARM Product Features:

- Grade 100 makes the process lighter and reduces the risk of potential manual handling injuries
- High visibility colour contrast connecting points

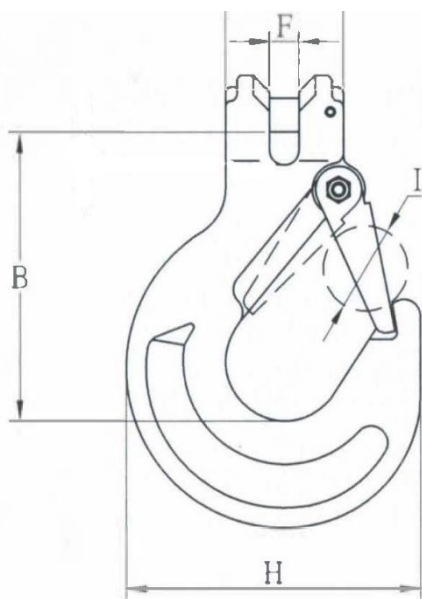

Bullivants Part No.	Chain Size mm	WLL t	B mm	F mm	H mm	I mm	Mass kg
WSLH-C-080-BVE-G100	8	2.5	85	10	87.8	24	0.61
WSLH-C-100-BVE-G100	10	4.0	100	11.5	112.9	29	1.02
WSLH-C-130-BVE-G100	13	6.7	126	15	132.1	37	1.78
WSLH-C-160-BVE-G100	16	10.0	173	18.5	173.2	48	4.42

All chain slings must be proof load tested after assembly in accordance with AS 3775.1