

Bullivants

Screw Cam Clamp

0.5 Tonne – 6.3 Tonne



Main Features:

- Multi use clamps that can be used in applications such as lifting, suspension, lateral (horizontal) pulling and turning of steel
- Hardness range: 80 – 300HB
- Equipped with a screw cam which provides a powerful clamping force on a work piece even when vibrations occur during operation
- Manufactured in Japan



ZERO HARM Product Features:

- Fitted with a visual indicating device to confirm minimum tightening torque is applied for safe use
- The torque sensing indicator is luminescent providing an additional safety check allowing visibility to confirm the clamp is tightened correctly when used in poor lighting conditions.



Torque Sensing Indicator to confirm correct tightening force:

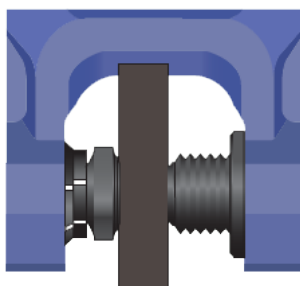

Non-Aligned
(non-alignment of lines)
Before tightening

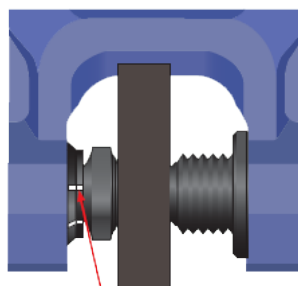

Aligned
(lines aligned)
After tightening (correct position)

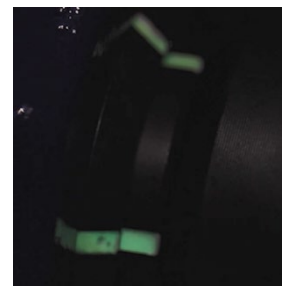

Luminescent
indicators

Bullivants

Screw Cam Clamp

0.5 Tonne – 6.3 Tonne



Specifications:

Bullivants Mfr No.	Rated Capacity t	Clamp Range mm	Unit Weight kg
WPC-U-0050-00-25-BV	0.5	0~25	1.9
WPC-U-0100-00-40-BV	1.0	0~40	3.6
WPC-U-0200-00-40-BV	2.0	0~40	4.8
WPC-U-0320-00-40-BV	3.2	0~40	7.0
WPC-U-0630-00-50-BV	6.3	0~50	16.0

Dimensions:

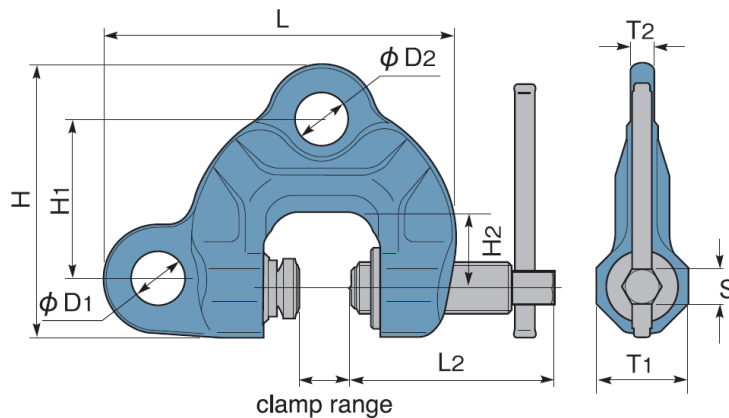

Rated Capacity t	L mm	L2 mm	H mm	H1 mm	H2 mm	D1 mm	D2 mm	T1 mm	T2 mm	S mm
0.5	158	89	121	71.5	30	27	27	46	13	17
1.0	208	121	161	94	45	32	32	54	14	21
2.0	227	121	177	105	45	36	32	60	18	21
3.2	252	136	196	118.5	50	45	35	64	20	21
6.3	291	152	225	132	55	50	41	90	43	21

Applications:

