



Home of the Tiger hoisting and winching range

Main Features:

- The original brake hand winch
- High quality multi-purpose winch
- Automatic load-actuated brake can hold the load in any position
- Compact, light-weight and rugged construction
- Gears and brakes fully covered to prevent dust, dirt and rain contamination
- Heavy Duty heat treated gears
- Very low operator effort required for easy operation
- Universal mounting plate
- Available as 370kg, 550kg, 820kg and 1200kg models
- Suitable for cable or strap
- Finished in high quality powder coat paint offering excellent corrosion protection
- Available with OCP corrosion protection
- Noiseless 1200lb model available
- 3D Drawings available on full range for project planning
- Operating temperature of -20°C to +80°C (temperature range of -40°C to +80°C available as an options)



BHW



BHW – Corrosion Protected

Tiger Brake Winch:

The Tiger Brake Winch is a high quality multi-purpose winch used for a wide variety of lifting and hoisting applications. The automatic brake ensures the load remains suspended when the crank is released and avoids unchecked descent of the load; there is no freewheeling making the hand winch extremely safe to operate. All the mechanical components are enclosed for protection against dust, dirt and rain contamination. This equipment has a lifting capacity ranging from 800lbs to 2600lbs. The BHW is compact and lightweight yet rugged and durable. These units meet and exceed all the requirements within BS EN 13157: 2004+A1:2009.



Tiger Brake Hand Winch – BHW

Certification:

Each unit comes fully certified with a test certificate or an EC Declaration of Conformity stating compliance with the essential health and safety requirements of the Machinery Directive 2006/42/EC.

Noiseless 1200lb Model:

This model is equipped with a unique quiet brake design that is virtually silent and fully automatic. Best suited to those locations where quiet is required, such as schools, hospitals, caravans and theatres.

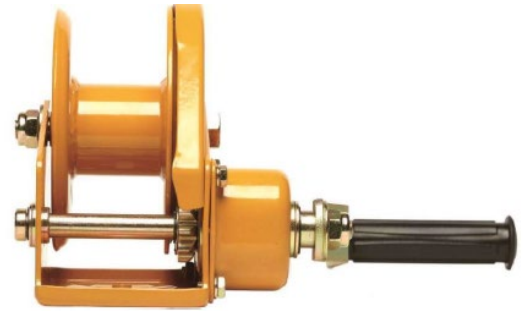

Corrosion Protection Option:

This model is protected by our unique coating – OCP (Organic Compound Protection).

The uniqueness of this coating gives unprecedented long term reliability and superior corrosion resistance and protection in the most severe conditions. The OCP coating provides excellent friction protection and has been proven to be effective through at least 1000 hours of the ASTM B 117 Salt Spray Test. The coating gives the properties of stainless steel without the cost implications.



Technical Data:

Bullivants Mfr No.	Lifting Capacity			Gear Ratio	Hub Dia Ø	Handle Length mm	Unit Weight kg	Wire Dia Ø mm/ inch	Wire Storage Cap. m	Strap Length m
	First Layer kg	Mid Layer kg	Top Layer kg							
WHW-NW-0370-BHW0800TG STANDARD BRAKE VERSION – NO WIRE	370	254	180	4.1:1	40	160	3.0	4 5/32	36	9.1
WHW-NW-0370-BHW0800CRTG (CORROSION RESISTANT) – NO WIRE	370	254	180	4.1:1	40	160	3.0	4 5/32	36	9.1
WHW-NW-0550-BHW1200TG STANDARD BRAKE VERSION – NO WIRE	550	392	275	4.1:1	50	210	3.5	5 3/16	23	8.5
WHW-NW-0550-BHW1200CRTG (CORROSION RESISTANT) – NO WIRE	550	392	275	4.1:1	50	210	3.5	5 3/16	23	8.5
WHW-NW-0550-BHW1200NTG (NOISELESS VERSION) – NO WIRE	550	392	275	4.1:1	50	210	3.5	5 3/16	23	8.5
WHW-NW-0820-BHW1800TG STANDARD BRAKE VERSION – NO WIRE	820	562	400	5:1	70	320	8.0	6 ¼	24	14.1
WHW-NW-BHW1800CRTG (CORROSION RESISTANT) – NO WIRE	820	562	400	5:1	70	320	8.0	6 ¼	24	14.1
WHW-NW-1200-BHW2600TG STANDARD BRAKE VERSION – NO WIRE	1200	844	590	10:1	82	320	10.5	8 5/16	18	10.6



Technical Data for Winches Supplied with Wire Rope:

Bullivants Mfr No.	Lifting Capacity kg			Gear Ratio	Hub Dia Ø	Handle Length mm	Unit Weight kg	Wire Dia Ø mm/ inch	Wire Length m
	First Layer	Mid Layer	Top Layer						
WHW-WW-0370-BHW0800TGR STANDARD BRAKE VERSION WITH WIRE	370	254	180	4.1:1	40	160	3.0	4 5/32	30
WHW-WW-0550-BHW1200TGR STANDARD BRAKE VERSION WITH WIRE	550	392	275	4.1:1	50	210	3.5	5 3/16	20
WHW-WW-0820-BHW1800TGR STANDARD BRAKE VERSION WITH WIRE	820	562	400	5:1	70	320	8.0	6 ¼	22
WHW-WW-1200-BHW2600TGR STANDARD BRAKE VERSION WITH WIRE	1200	844	590	10:1	82	320	10.5	8 5/16	16

Winch Straps: (for pulling only)

Bullivants Mfr No.	Description	Width mm	Breaking Load kg	To Suit
WHWP-RS-TG48	6 meters with safety hook	48	2968.5	BHW-0800 BHW-1200
WHWP-RS-TG54	9 meters with safety hook	54	2864.0	BHW-1800
WHWP-RS-TG60	9 meters with safety hook	60	4136	BHW-2600





Technical Drawings:

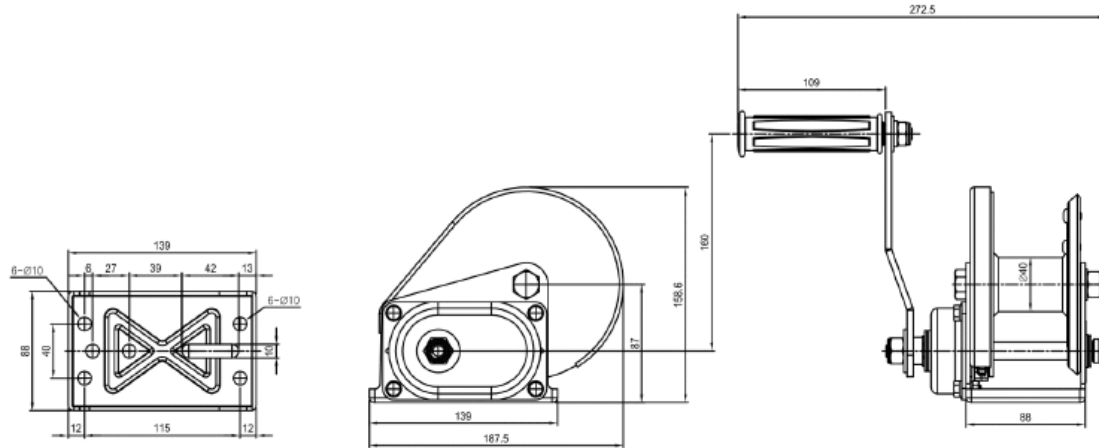

BHW-800

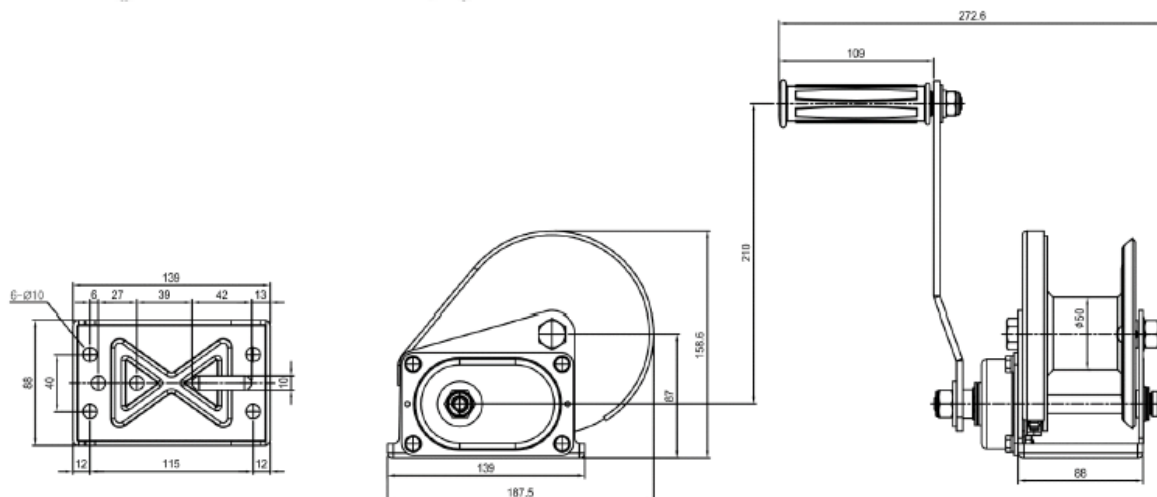

BHW-1200

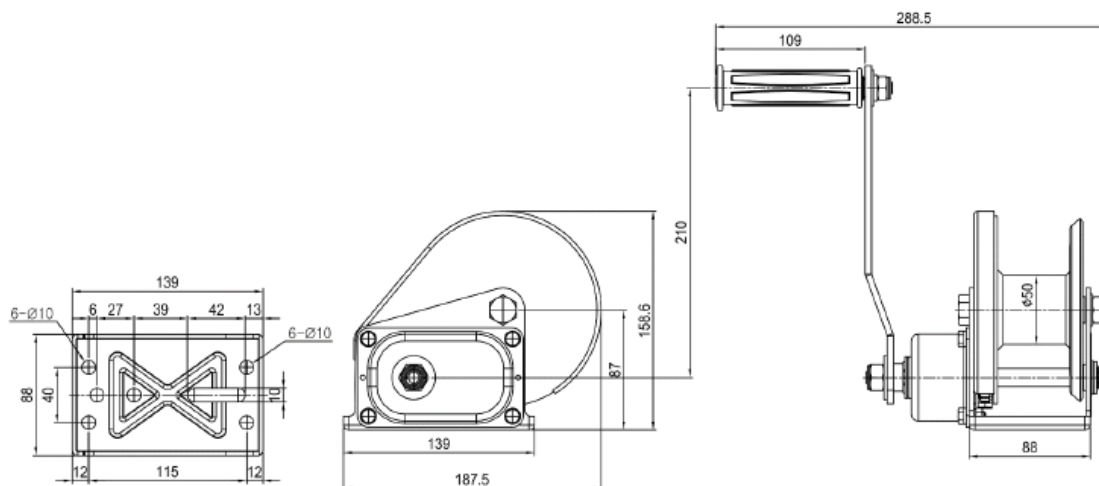

BHW-1200-N

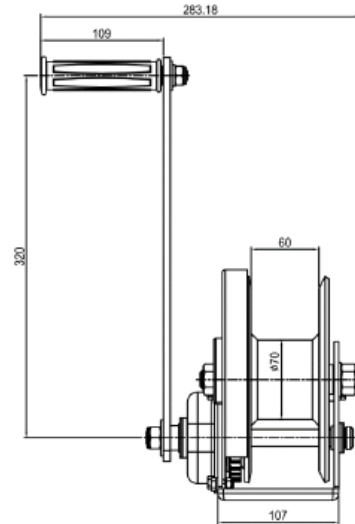
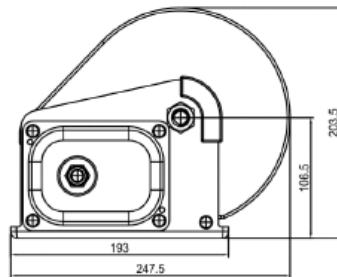
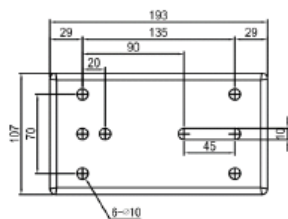

BHW-1800

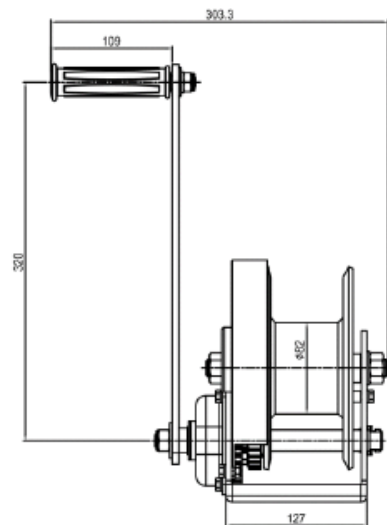
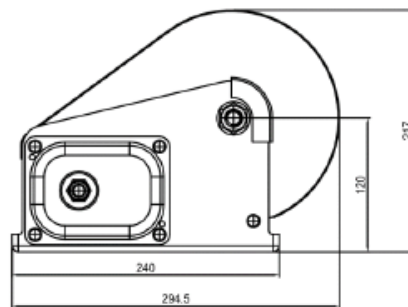
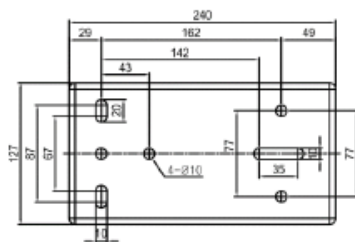

BHW-2600